

Properties for Sale

1 Central & Nisqualli, Apple Valley, CA 92307



Price \$595,000
Lot Size 7.66 AC
Property Sub-type Multifamily (land)
Broker Information Mehdi Mostaedi
(760) 684-8044
Status Active
LoopNet ID 17897620

Property Notes

Listing's Link: <http://www.loopnet.com/lid/17897620>

Lots

#	Price	Size	Price/Size	Description
	\$595,000	\$77,676.24 /AC	7.66 AC	

Property Description

±7.66 acres vacant land on the Southwest Corner of Nisqually & Central Road in Apple Valley. Just south of Highway 18. Property is zoned Multi-Family allowing 20 units per acre. Can build around 150 units. Close to schools and shopping centers. Easy access to I-15 Freeway

2 Bear Valley and Valley Vista, Apple Valley, CA 92307



Price \$60,000
Lot Size 4.84 AC
Property Sub-type Residential (land)
Broker Information James Langley
(760) 983-2383 Ext: 102
Status Active
LoopNet ID 17714562

Property Notes

Listing's Link: <http://www.loopnet.com/lid/17714562>

Lots

#	Price	Size	Price/Size	Description
	\$60,000	\$12,396.69 /AC	4.84 AC	

Property Description

The ±4.84 Acres located on the north side of Bear Valley Road is just a ±1/2 mile east of Joshua Road on the northwest corner of Valley Vista Road and Bear Valley Road. This parcel is located in the sphere of influence of the Town of Apple Valley. The zoning is Rural Residential but may have potential for General Commercial zoning. The property is in close proximity to a few rural residential homes to the south and ±1.5 miles east of the Ultra Star Theater on Central Road and Bear Valley Road.

3 Siskiyou Rd, Apple Valley, CA 92307



Price \$160,000
Lot Size 1.70 AC
Property Sub-type Residential (land)
Broker Information Ken Parker
(760) 951-9050
Status Active
LoopNet ID 17632301

Property Notes

Listing's Link: <http://www.loopnet.com/lid/17632301>

Lots

#	Price	Size	Price/Size	Description
227	\$160,000	\$94,117.64 /AC	1.70 AC	Tentative subdivision map for 16 units using all three parcels

Property Description

Own 16 units on this Prestigious Corner in Apple Valley! There are three parcels included in this sale lot 227, 228, and 229 - all R-2 land for Multi-Family. Seller has a tentative subdivision map for 16 units using all three parcels. Final approval has not been granted by the Town Planning Department as of this date. Buyer to verify with Planning Department. One of Sellers is a licensed R.E. Agent in California, acting as a principal and will not receive a commission from this sale.

4 Yucca Loma Rd, Apple Valley, CA 92307



Price \$220,000
Lot Size 20 AC
Property Sub-type Residential (land)
Broker Information Scott Lisk
(951) 346-0805
Status Active
LoopNet ID 17605982

Property Notes

Listing's Link: <http://www.loopnet.com/lid/17605982>

Lots

#	Price	Size	Price/Size	Description
	\$220,000	\$11,000 /AC	20 AC	

Property Description

±20 Acres Residential Land, Unincorporated San Bernardino County in the Apple Valley Area. Most Utilities Available - Needs to be researched & confirmed. Assessor's Parcel Number 0439-081-21. SUBMIT OFFERS!

5 Kiowa Rd, Apple Valley, CA 92308

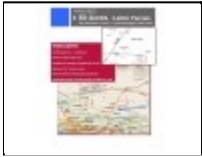

Price \$500,000
 Lot Size 80 AC
 Property Sub-type Residential (land)
 Broker Information Scott Lisk
 (951) 346-0805
 Status Active
 LoopNet ID 17569063

Property Notes

Listing's Link: <http://www.loopnet.com/lid/17569063>

Lots

#	Price	Size	Price/Size	Description
	\$500,000	\$6,250 /AC	80 AC	

Property Description

±80 Acres, 2-40Ac Parcels. Adjacent Acreage Available (80 Acres). Property is Zoned "RL" Rural Living, Zone Allows Planned Developments. Assessor's Parcel #'s 0433-013-09 & 10.

6 Castle Rock Rd, Apple Valley, CA 92308



Price \$500,000
 Lot Size 80 AC
 Property Sub-type Residential (land)
 Broker Information Scott Lisk
 (951) 346-0805
 Status Active
 LoopNet ID 17568834

Property Notes

Listing's Link: <http://www.loopnet.com/lid/17568834>

Lots

#	Price	Size	Price/Size	Description
	\$500,000	\$6,250 /AC	80 AC	

Property Description

±80 Acres Investment / Development Opportunity. Hesperia / Apple Valley Area, San Bernardino County. Assessor's Parcel # 0433-013-11. Site is Priced "Below" Assessed Value. Zoning is RL (Rural Living). Two Adjacent 40-Acre Parcels Available.

7 Central, Apple Valley, CA 92307



Price	\$15,000	Property Notes
Lot Size	0.36 AC	
Property Sub-type	Residential (land)	
Broker Information	James Langley (760) 983-2383 Ext: 102	
Status	Active	
LoopNet ID	17222718	

Listing's Link: <http://www.loopnet.com/lid/17222718>

Lots

#	Price	Size	Price/Size	Description
1	\$15,000	\$41,666.67 /AC	0.36 AC	

Property Description

Located on the east side of Central Road just south of Sitting Bull Road in the Town of Apple Valley. This property is zoned for 1 single family residence and is priced to sell. most utilities to the site(Buyer to verify). 1 mile north of this property on Highway 18 the Mojave Water Agency just opened their \$10 million facility. 3/4th of a mile south of this property is the Ultrastar movie theater and shopping center that was built in 2007. The remainder of the shopping center was never finished but was recently acquired by a new developer. This area is also in the middle of the proposed developments that were planned prior to the market crash. Multiple Land Bankers have acquired property in this area in anticipation of the next residential wave. The sellers are motivated and will look at all offers. Property Information Flyer Attached

8 Rancherias Road & Seneca Road, Apple Valley, CA 92307



Price	\$130,000	Property Notes
Lot Size	2.50 AC	
Property Sub-type	Residential (land)	
Broker Information	William Flaherty (909) 772-7949	
Status	Active	
LoopNet ID	17142493	

Listing's Link: <http://www.loopnet.com/lid/17142493>

Lots

#	Price	Size	Price/Size	Description
2564	\$130,000	\$52,000 /AC	2.50 AC	SECOND PRICE REDUCTION!!!! Rectangular 2.5 acre flat residential lot across the street from Apple Valley Country Club.

Property Description

Flat, spacious 2.5 acre lot with all utilities at street. Beautiful area in Apple Valley Country Club..



Price \$300,000
 Lot Size 30 AC
 Property Sub-type Residential (land)
 Broker Information David Pronenko
 (949) 422-2319
 Status Active
 LoopNet ID 17037909

Property Notes

Listing's Link: <http://www.loopnet.com/lid/17037909>

Lots

#	Price	Size	Price/Size	Description
22	\$300,000	\$10,000 /AC	30 AC	

Property Description

30 Acres with flat topology. Property is designated "Rural Living" with 2.50 acre minimum parcel size.



Price \$999,000
 Lot Size 40 AC
 Property Sub-type Residential (land)
 Broker Information Brett and Cathy Bayless
 (760) 955-0003 Ext: 104
 Status Active
 LoopNet ID 16263434

Property Notes

Listing's Link: <http://www.loopnet.com/lid/16263434>

Lots

#	Price	Size	Price/Size	Description
	\$999,000	\$24,975 /AC	40 AC	

Property Description

PRICE REDUCED-Exceptional properties like this don't come on the market often at this Low Price! Property has a Commanding Million Dollar Views and is situated High on the Hillside east of Hesperia Lakes overlooking the Mojave River, Apple Valley, Hesperia and Victorville cities. Located in an unincorporated area of Apple Valley excellent for Upscale Homes. Property would make a Great Ranch Estate or an Excellent Development for million dollar homes. There are many trails in the area for horses and recreational vehicles. Parcel has gradual slope to flat. Electricity and Telephone are adjacent to property. Currently zoned RL 20ac with possible rezoning 2.5ac or smaller per San Bernardino County Planning (buyer to verify). Approx 10-15 min away from a major commercial center at Jess Ranch Market Place. Pictures nor virtual tour don't do this property justice. See this Property Firsthand and You Will be Impress! Seller will listen to all Offers!



Price \$297,000
 Lot Size 1.35 AC
 Property Sub-type Residential (land)
 Broker Information Mohammad Alam
 (760) 247-6655
 Status Active
 LoopNet ID 17894300

Property Notes

Listing's Link: <http://www.loopnet.com/lid/17894300>

Lots

#	Price	Size	Price/Size	Description
2965	\$297,000	\$220,022.45 /AC	1.35 AC	

Property Description

STANDARD SALE. NOT A SHORT SALE / REO. QUICK RESPONSE TO ALL OFFERS. Absolutely gorgeous & Luxury home estate located in the desirable & prestigious neighborhood. Million dollar estates all around. The house & pool has been remodeled. Newer A/C units, 18 inch custom tiles & wood floor. To of the line granite counter tops in kitchen & bathrooms, custom paint, cabinets, lighting, fixtures, blinds throughout. The home sits on corner lot with block wall & wrought iron fencing. Circular drive way, security gates, RV parking & double car garage. Front has courtyard & porch to double doors grand entrance. Sunken formal living room, large formal dining room, separate family room with fireplace, giant game room. Indoor laundry room has sink, counters & cabinets. Huge bedrooms with mirror door closets & walk in closets. There are 2 masters; primary master has a retreat & computer area. Master bath room is HUGE has corner tub, stall shower, his & her closets, double sinks & vanity area. BEST BUY!



Price \$65,000
 Lot Size 8.33 AC
 Property Sub-type Residential (land)
 Broker Information Coldwell Banker Commercial
 (760) 684-8000
 Status Active
 LoopNet ID 17891646

Property Notes

Listing's Link: <http://www.loopnet.com/lid/17891646>

Lots

#	Price	Size	Price/Size	Description
	\$65,000	\$7,803.12 /AC	8.33 AC	

Property Description

Some rolling Hills with Beautiful View

13 Round Up, Apple Valley, CA 92307



Price \$65,000
Lot Size 10 AC
Property Sub-type Residential (land)
Broker Information Coldwell Banker Commercial
(760) 684-8000
Status Active
LoopNet ID 17891608

Property Notes

Listing's Link: <http://www.loopnet.com/lid/17891608>

Lots

#	Price	Size	Price/Size	Description
	\$65,000	\$6,500 /AC	10 AC	

Property Description

Flat usable Residential Land on 10 Acres

14 Las Tunes rd, Apple Valley, CA 92307



Price \$5,500
Lot Size 10 AC
Property Sub-type Residential (land)
Broker Information Coldwell Banker Commercial
(760) 684-8000
Status Active
LoopNet ID 17891570

Property Notes

Listing's Link: <http://www.loopnet.com/lid/17891570>

Lots

#	Price	Size	Price/Size	Description
	\$5,500	\$550 /AC	10 AC	

Property Description

\$55,000 per parcel. Flat 5 acre lots

15 luna Mountain Rd, Apple Valley, CA 92307



Price \$60,000
 Lot Size 8.87 AC
 Property Sub-type Residential (land)
 Broker Information Coldwell Banker Commercial
 (760) 684-8000
 Status Active
 LoopNet ID 17891548

Property Notes

Listing's Link: <http://www.loopnet.com/lid/17891548>

Lots

#	Price	Size	Price/Size	Description
	\$60,000	\$6,764.37 /AC	8.87 AC	

Property Description

Some Rolling Hills with Beautiful View

16 Bellview, Apple Valley, CA 92307



Price \$65,000
 Lot Size 20 AC
 Property Sub-type Residential (land)
 Broker Information Coldwell Banker Commercial
 (760) 684-8000
 Status Active
 LoopNet ID 17891533

Property Notes

Listing's Link: <http://www.loopnet.com/lid/17891533>

Lots

#	Price	Size	Price/Size	Description
	\$65,000	\$3,250 /AC	20 AC	

Property Description

Two 10 Acre parcels with beautiful view

17 Community Way, Apple Valley, CA 92308



Price \$9,900
 Lot Size 0.07 AC
 Property Sub-type Residential (land)
 Broker Information Tammy Tengs
 (760) 219-3313
 Status Active
 LoopNet ID 17880087

Property Notes

Listing's Link: <http://www.loopnet.com/lid/17880087>

Lots

#	Price	Size	Price/Size	Description
	\$9,900	\$134,693.88 /AC	0.07 AC	

Property Description

Jess Ranch residential lot for investment! Located just south of Victor Valley College and a major shopping area with lots of stores and restaurants. Buy now at this low price and be in great shape when the next housing boom comes! Dimensions are 40 ft wide by 80 ft deep.

18 0 Kiowa, Apple Valley, CA 92308



Price \$580,000
 Lot Size 21.21 AC
 Property Sub-type Residential (land)
 Broker Information Hamid Rohnian
 (310) 508-5054
 Status Active
 LoopNet ID 17877001

Property Notes

Listing's Link: <http://www.loopnet.com/lid/17877001>

Lots

#	Price	Size	Price/Size	Description
	\$580,000	\$27,345.61 /AC	21.21 AC	

Property Description

Prime Apx.26.6 acres land with TTMAP approved for 44 Half acres lot located at N/W corner of Kiowa and Tussing Ranch Rd. It is 1.25 miles South of Bear Valley Rd, on Kiowa/Tussing Ranch Rd.. TTMAP# 17615

19 Ocatillo E. on Bear Vally Rd., Kiowa (Turn R) go South (1.5 Miles) to Ocotillo (Make lef).N/W Navajo, Apple Valley, CA 92308



Price \$1,950,000
Lot Size 120 AC
Property Sub-type Residential (land)
Broker Information Hamid Roknian
(310) 508-5054
Status Active
LoopNet ID 17876756

Property Notes

Listing's Link: <http://www.loopnet.com/lid/17876756>

Lots

#	Price	Size	Price/Size	Description
	\$1,950,000	\$16,250 /AC	120 AC	

Property Description

Prime 120 acres with TTMAP approved for 100 One acre TTMAP# 17724. In the area of Estate homes, with excellent view. Located on N/W corner of Ocotillo and Navajo. Electric, Gas,water and Telephone in the street/At the site. Asking Price only \$16,250 per acre. There is also 44Half acres lot located about 0.5 miles away form this property The two projects may be purchased together or separately.These two parcel can be packaged together or sold separately. Owner Financing available.

20 19417 Verbena St, Apple Valley, CA 92308

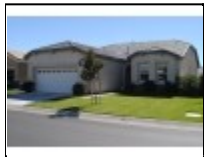

Price \$219,900
Lot Size 0.12 AC
Property Sub-type Residential (land)
Broker Information Mohammad Alam
(760) 247-6655
Status Active
LoopNet ID 17872429

Property Notes

Listing's Link: <http://www.loopnet.com/lid/17872429>

Lots

#	Price	Size	Price/Size	Description
314	\$219,900	\$1,798,506.20 /AC	0.12 AC	

Property Description

This golf course home is located in the 55+ guard gated community of Sun City. RESORT LIKE LIVING with world class amenities includes country club, indoor/outdoor pool, gym, library, computer area, tennis court, out door BBQ area, community room & etc. PANORAMIC MILLION DOLLAR VIEW!! When you walk into this beautiful home your eyes will be immediately drawn to look out the windows to the breath taking views of the lake, golf course & mountain views. Spacious Open Floor Plan & Shows like a Model. Hawthorne Model Featuring 2 Bedrooms plus a Bonus Room or a 3rd bedroom. Gourmet kitchen with corian countertops & large bar area. Nice size dining area. Huge living room with fireplace and wall to wall picture windows to enjoy the view. Master Suite looks out to the amazing views of the golf course. The master features a garden tub, separate shower; walk-in closet is a size of a bedroom, double sinks. The seller paid approx. \$70,000.00 a lot upgrade to be on the golf course & lake view.



Price \$300,000
 Lot Size 20 AC
 Property Sub-type Residential (land)
 Broker Information Stacey Nikac
 (760) 241-5211 Ext: 234
 Status Active
 LoopNet ID 17852635

Property Notes

Listing's Link: <http://www.loopnet.com/lid/17852635>

Lots

#	Price	Size	Price/Size	Description
	\$300,000	\$15,000 /AC	20 AC	

Property Description

Airport land. own your own spot on a private air park. Build your home and store your plane on your driveway. Beautiful views, rural living at its best.



Price \$39,000
 Lot Size 5 AC
 Property Sub-type Residential (land)
 Broker Information don salazar
 (760) 662-1044
 Status Active
 LoopNet ID 17845066

Property Notes

Listing's Link: <http://www.loopnet.com/lid/17845066>

Lots

#	Price	Size	Price/Size	Description
	\$39,000	\$7,800 /AC	5 AC	

Property Description

Flat 5 acres Ready to build , Utilities close by all on Paved Road



Price \$39,000
 Lot Size 5 AC
 Property Sub-type Residential (land)
 Broker Information don salazar
 (760) 662-1044
 Status Active
 LoopNet ID 17845063

Property Notes

Listing's Link: <http://www.loopnet.com/lid/17845063>

Lots

#	Price	Size	Price/Size	Description
	\$39,000	\$7,800 /AC	5 AC	

Property Description

Flat % acres Ready to build or Land Bank, utilities close by, have topo of lot goes with buyer



Price \$79,000
 Lot Size 0.99 AC
 Property Sub-type Multifamily (land)
 Broker Information Andy Mandegary
 (949) 689-0417
 Status Active
 LoopNet ID 17844938

Property Notes

Listing's Link: <http://www.loopnet.com/lid/17844938>

Lots

#	Price	Size	Price/Size	Description
	\$79,000	\$79,658.33 /AC	0.99 AC	CORNER OF POWHATAN AND YAKIMA RD TG # 4387H2

Property Description

43,200 SQ FT FLAT CORNER LOT IN APPLE VALLEY. CLOSE TO SCHOOL , SHOPPING , HWY 18 ,YOU CAN BUILT UP TO 15 UNITS IN ONE ACRE LOT.. ALL UTILITIES ARE AVAILABLE.



Price \$449,000
 Lot Size 37.81 AC
 Property Sub-type Residential (land)
 Broker Information James Millus
 (760) 241-5211
 Status Active
 LoopNet ID 17844122

Property Notes

Listing's Link: <http://www.loopnet.com/lid/17844122>

Lots

#	Price	Size	Price/Size	Description
	\$449,000	\$11,875.16 /AC	37.81 AC	

Property Description

Proeprty zoned R1. Proposed use is single family development. Land is level, irregular shape and is raw. Boats 1,338 feet on Del Oro Road.



Price \$45,000
 Lot Size 2.50 AC
 Property Sub-type Residential (land)
 Broker Information Ask for Listing Agent
 (818) 906-1000
 Status Active
 LoopNet ID 17814631

Property Notes

Listing's Link: <http://www.loopnet.com/lid/17814631>

Lots

#	Price	Size	Price/Size	Description
	\$45,000	\$18,000 /AC	2.50 AC	

Property Description

Land for sale



Price \$808,500
 Lot Size 53.90 AC
 Property Sub-type Residential (land)
 Broker Information James Millus
 (760) 241-5211
 Status Active
 LoopNet ID 17804229

Property Notes

Listing's Link: <http://www.loopnet.com/lid/17804229>

Lots

#	Price	Size	Price/Size	Description
	\$808,500	\$15,000 /AC	53.90 AC	

Property Description

8 parcels total. 3080-061-15 through 22. Tentative tract map 80% complete. Great location in the path of housing development. Zone R-1. Very motivated seller. 1 unit per acre.



Price \$249,000
 Lot Size 10 AC
 Property Sub-type Residential (land)
 Broker Information Joseph Brady
 (760) 951-5111 Ext: 103
 Status Active
 LoopNet ID 17794353

Property Notes

Listing's Link: <http://www.loopnet.com/lid/17794353>

Lots

#	Price	Size	Price/Size	Description
n/a	\$249,000	\$24,900 /AC	10 AC	

Property Description

Zoning: EQ (Equestrian Residential) 1 dwelling per 0.4 to 0.9 Acres Surrounded by existing housing tracts. Close to surrounding schools Great piece of property for future investment Seller to look at all offers

29 Potomac Road, Apple Valley, CA 92307



Price \$150,000
Lot Size 0.82 AC
Property Sub-type Multifamily (land)
Broker Information Mary Wen
(626) 367-4116
Status Active
LoopNet ID 17780305

Property Notes

Listing's Link: <http://www.loopnet.com/lid/17780305>

Lots

#	Price	Size	Price/Size	Description
51	\$150,000	\$182,005.57 /AC	0.82 AC	

Property Description

Vacant Land in Apple Valley. Great Investment Opportunity. The high intensity traffic areas of AV. Zoned for multiple res. units; owner had been approved by the city to build with 8 units. Ready for its best use; in the same tract commercial condors were already built and leased out. No waiting time!

30 Central Rd. & Dale Evans Parkway, Apple Valley, CA 92307



Price \$19,990
Lot Size 5 AC
Property Sub-type Residential (land)
Broker Information Mohammad Alam
(760) 247-6655
Status Active
LoopNet ID 17773016

Property Notes

Listing's Link: <http://www.loopnet.com/lid/17773016>

Lots

#	Price	Size	Price/Size	Description
0	\$19,990	\$3,998 /AC	5 AC	338 X 662

Property Description

5 acre land located right on Central Rd and just south of Stoddard Wells Road. Land is located Near Wal-Mart Distribution Center. The subject land is almost right across from Grange MC Kart race track, a well-known motor cross. This land could be a great use for recreation purposes such as camping, RV or motor homes parking. Bring your toys and enjoy. Gorgeous panoramic view of the surrounding valley, mountains and the peaceful desert from this property. You can see miles after miles from this land. This area of Apple Valley is growing fast and this land is right on the path of immediate growth. The proposed E-220 High Desert Corridor is coming right by this property. Such a great investment property!! Buy now at rock bottom price and make huge profit in near future. Not many 5 acres at this price on the market. Seller may do seller financing. Grab this opportunity and buy this land today!!



Price \$135,000
 Lot Size 20 AC
 Property Sub-type Residential (land)
 Broker Information Mohammad Alam
 (760) 247-6655
 Status Active
 LoopNet ID 17761455

Property Notes

Listing's Link: <http://www.loopnet.com/lid/17761455>

Lots

#	Price	Size	Price/Size	Description
0	\$135,000	\$6,750 /AC	20 AC	

Property Description

GREAT BUY FOR THE MONEY!! 20 Acre level and buildable land on Tussing Ranch Rd of Apple Valley near Ranch Marianas. PERFECT 20 ACRE FOR A SOLAR ENERGY PROJECT. This 20 acre may be subdivided to minimum of 1 acre parcels. There 2 parcels with Parcel numbers 0434-124-23 & 24 are being sold together to make it 20 acres for the asking price. You can keep the 5 acre and sell the 15 acre later or do whatever you like. This 20 acre has lots of possibility. All utility near the land. Panoramic view of the mountains, valley, desert and city lights. A great area to build for view homes. Own this 20 acre today while price still cheap. This could be a huge profitable investment for near future. Motivated seller may do seller financing with 50% down at low interest for 2 years. Call for more details. Buyer to verify zoning, subdivision, size and all other information.



Price \$109,000
 Lot Size 20 AC
 Property Sub-type Residential (land)
 Broker Information Mohammad Alam
 (760) 247-6655
 Status Active
 LoopNet ID 17761439

Property Notes

Listing's Link: <http://www.loopnet.com/lid/17761439>

Lots

#	Price	Size	Price/Size	Description
	\$109,000	\$5,450 /AC	20 AC	

Property Description

20 ACRE LAND WITH PRIVATE WATER WELL, ELECTRICITY, AND FENCING!! The land has Gorgeous 360 Panoramic view of the mountains, beautiful standing rocks, and Victor valley. From this property you can see the spectacular view of the night with city lights and twinkling stars in the perfect clear sky. The land Located in the peaceful Fairview Valley. This 20 acre is ready to build your dream ranch home estate. You can live a country life within minutes of downtown Apple Valley. The land has a private well, electricity, fully-fenced, underground irrigation system with several spigots, storage shed. Zoned for horses, livestock, and/or a dog kennel. This 20 acre may be subdivided to more parcels. A nice manufactured home can be easily put on this land. THE LAND HAS LOTS OF POSSIBILITY. Did you notice the price? The lowest priced 20 acre with fencing and water well in the entire area. Don't waste your time looking this land is the BEST BUY. Motivated seller may do seller financing

33 Outer Hwy 18, Apple Valley, CA 92307



Price \$39,900
Lot Size 0.51 AC
Property Sub-type Multifamily (land)
Broker Information John Connolly
(760) 243-2205
Status Active
LoopNet ID 17735758

Property Notes

Listing's Link: <http://www.loopnet.com/lid/17735758>

Lots

#	Price	Size	Price/Size	Description
	\$39,900	\$78,233.89 /AC	0.51 AC	

Property Description

R3 lot on 1/2 acre situated on Outer Hwy 18 surrounded by existing apartmetns and commercial. Great for 8 units (possibly more-check with town of Apple Valley) Just 4 lots east of Tao Road next to existing units.

34 Gustine and Mesquite Rd, Apple Valley, CA 92307

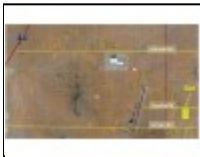

Price \$119,000
Lot Size 20 AC
Property Sub-type Residential (land)
Broker Information Coldwell Banker Commercial
(760) 684-8000
Status Active
LoopNet ID 17731762

Property Notes

Listing's Link: <http://www.loopnet.com/lid/17731762>

Lots

#	Price	Size	Price/Size	Description
	\$119,000	\$5,950 /AC	20 AC	

Property Description

20 acres residential land fronting Gustine Road in Apple Valley.



Price \$218,000
 Lot Size 10 AC
 Property Sub-type Residential (land)
 Broker Information randy funder
 (760) 242-1267
 Status Active
 LoopNet ID 17730628

Property Notes

Listing's Link: <http://www.loopnet.com/lid/17730628>

Lots

#	Price	Size	Price/Size	Description
0436-144	\$218,000	\$21,800 /AC	10 AC	HILL AND COVE , AND LEVAL BUILDABLE SUPER VIEW LOT 10 ACRES PRIME 760-242-1267 330X 1320 FEET SURVEYED , ELECTRICITY READY TO BUILD AWSOME help a brother....buy my ranch land.

Property Description

hill and 10 acre super valley view , land and hill 3600ft high 760-242-1267 760-242-1267 ask for rwf must sell electricity installed to lot, pole and utility,\$\$, 21/2 acres wide 1320 feet deep trade r v , cash all offers has view of valley , apple valley address, you will have to have water well both propertys adjacent have water wells, water is fresh well aqua fishers water 167feet deep taxes current , clear deed to propertysee to appreciate



Price \$30,000
 Lot Size 10 AC
 Property Sub-type Residential (land)
 Broker Information Rudy Provoost
 (909) 631-4510
 Status Active
 LoopNet ID 17623484

Property Notes

Listing's Link: <http://www.loopnet.com/lid/17623484>

Lots

#	Price	Size	Price/Size	Description
	\$30,000	\$3,000 /AC	10 AC	

Property Description

This 10 acre site is nestled in the foothills. This property offers breath taking views of the desert. This is your opportunity to purchase a large piece of land at an affordable price. You can have your own desert getaway but still be in the vicinity of all your needs with this property being located in the Sphere of Influence of Apple Valley, CA. Build your home atop a mountain



Price \$70,000
 Lot Size 5 AC
 Property Sub-type Residential (land)
 Broker Information Ken Parker
 (760) 951-9050
 Status Active
 LoopNet ID 17570366

Property Notes

Listing's Link: <http://www.loopnet.com/lid/17570366>

Lots

#	Price	Size	Price/Size	Description
	\$70,000	\$14,000 /AC	5 AC	5 acre parcel

Property Description

MILLION DOLLAR VIEW!!!!Beautiful 5 acre parcel with unobstructed views of the whole valley. Show to your upscale home builder clients and investors. This is a definite must see. -----



Price \$100,000
 Lot Size 9.25 AC
 Property Sub-type Residential (land)
 Broker Information Coldwell Banker Commercial
 (760) 684-8000
 Status Active
 LoopNet ID 17491707

Property Notes

Listing's Link: <http://www.loopnet.com/lid/17491707>

Lots

#	Price	Size	Price/Size	Description
	\$100,000	\$10,810.81 /AC	9.25 AC	

Property Description

This is an excellent investment property at a great price. Easy access to Highway 18 with frontage on Joshua. Easy access to shopping centers including Super Target, Walmart, Albertsons and Ralphs. Also close proximity to Apple Valley Town Center.



Price \$19,000
 Lot Size 10 AC
 Property Sub-type Residential (land)
 Broker Information Craig Potter
 (951) 454-2359
 Status Active
 LoopNet ID 17450605

Property Notes

Listing's Link: <http://www.loopnet.com/lid/17450605>

Lots

#	Price	Size	Price/Size	Description
46	\$19,000	\$1,900 /AC	10 AC	

Property Description

This 10 acres is perfect for an investor.



Price \$10,000
 Lot Size 2.50 AC
 Property Sub-type Multifamily (land)
 Broker Information Johnny Yoo
 (714) 530-5295
 Status Active
 LoopNet ID 17331495

Property Notes

Listing's Link: <http://www.loopnet.com/lid/17331495>

Lots

#	Price	Size	Price/Size	Description
	\$10,000	\$4,000 /AC	2.50 AC	

Property Description



Price \$20,000
 Lot Size 4.25 AC
 Property Sub-type Residential (land)
 Broker Information Ken Parker
 (760) 951-9050
 Status Active
 LoopNet ID 17297705

Property Notes

Listing's Link: <http://www.loopnet.com/lid/17297705>

Lots

#	Price	Size	Price/Size	Description
45	\$20,000	\$4,705.88 /AC	4.25 AC	Built to suit

Property Description

Great Piece of land to build on. Utilites near by



Price \$699,900
 Lot Size 20 AC
 Property Sub-type Residential (land)
 Broker Information Hector Alvarez
 (562) 805-3060
 Status Active
 LoopNet ID 17241489

Property Notes

Listing's Link: <http://www.loopnet.com/lid/17241489>

Lots

#	Price	Size	Price/Size	Description
33	\$699,900	\$34,995 /AC	20 AC	

Property Description

CUSTOM BUILT HOME 2007 SITUATED ON 20 ACRES, COMPLETELY FENCED. ALL ROOMS ARE GENEROUS IN SIZE. CENTRAL AIR SYSTEMS. LOTS OF STORAGE. 10 FOOT CEILINGS. LOT CAN BE SUBDIVIDED FOR MORE HOMES, MANY CUSTOM UP-GRADES/FEATURES. FOUR BEDROMS 3 FULL BATH EACH W/SPA. FENCE ALL AROUND OF THE 20 ACRES.



Price \$249,000
 Lot Size 40 AC
 Property Sub-type Residential (land)
 Broker Information Jeff Lunnen
 (949) 279-5645
 Status Active
 LoopNet ID 17199207

Property Notes

Listing's Link: <http://www.loopnet.com/lid/17199207>

Lots

#	Price	Size	Price/Size	Description
	\$249,000	\$6,225 /AC	40 AC	

Property Description

This opportunity represents a chance to purchase 59 half acre lots, tentative map approved. The property is approximately 40 acres and fronts the paved road Standing Rock Road, the subdivision is planned for half acre homes sites. Located in the County of San Bernardino. Great Access to Hwy 18 & close proximity to Southern California Logistical Airport. SCLA is a 8,500-acre multimodal transportation hub (Foreign Trade Zone) for air, ground, and rail: Southern California Logistics Airport, Logistics Center, and Rail Complex. APN: 0437-063-19



Price \$298,000
 Lot Size 10 AC
 Property Sub-type Multifamily (land)
 Broker Information randy funder
 (760) 242-1267
 Status Active
 LoopNet ID 17184569

Property Notes

Listing's Link: <http://www.loopnet.com/lid/17184569>

Lots

#	Price	Size	Price/Size	Description
10acres	\$298,000	\$29,800 /AC	10 AC	10 acre view land with hill, 330 x 1332ft, READY TO BUILD , taxes current make bid 760-242-1267

Property Description

you may put a nice ranch home,&casits or multiple mobile homes , super duper apple valley, califrnia hill cove and buildable 10 acre/ a super private view lot, north 1/4 mile off hwy 18 330 x 1320 feet 10 acres 760-242-1267 make offer /trade for rv and cash hill 3500 foot high part of property.....surveyed already has electricity intalled to lot, utilitys and pole , really private awsome view, all taxes are current.....call 760-242-1267 make offer

45 Apple Valley, CA, Apple Valley, CA 92307



Price \$45,000
 Lot Size 4.76 AC
 Property Sub-type Multifamily (land)
 Broker Information Johnny Yoo
 (714) 530-5295
 Status Active
 LoopNet ID 17173861

Property Notes

Listing's Link: <http://www.loopnet.com/lid/17173861>

Lots

#	Price	Size	Price/Size	Description
	\$45,000	\$9,453.78 /AC	4.76 AC	

Property Description

N.1/2,Sec.10, T.6N.,R.3W.

46 Johnson Road, Apple Valley, CA 92307



Price \$89,000
 Lot Size 2.50 AC
 Property Sub-type Multifamily (land)
 Broker Information Capital Holdings, Inc.
 (909) 476-9800
 Status Active
 LoopNet ID 17142922

Property Notes

Listing's Link: <http://www.loopnet.com/lid/17142922>

Lots

#	Price	Size	Price/Size	Description
	\$89,000	\$35,600 /AC	2.50 AC	

Property Description

2.5 acre property zoned multiple family residential (MFR). South of Johnson Rd and west of Dale Evans Parkway. Right next door to Wal-Mart Distribution Center with good access to I-15!



Price \$64,900
 Lot Size 12.75 AC
 Property Sub-type Multifamily (land)
 Broker Information Mehdi Mostaedi
 (760) 684-8044
 Status Active
 LoopNet ID 17127492

Property Notes

Listing's Link: <http://www.loopnet.com/lid/17127492>

Lots

#	Price	Size	Price/Size	Description
1	\$64,900	\$5,090.20 /AC	12.75 AC	

Property Description

Approx. 12.75 acres RM zoned (multifamily) land with approval for 140 units. Centrally Located to shopping, public transit and parks. Architectural and civil drawings 90% complete.



Price \$99,000
 Lot Size 5 AC
 Property Sub-type Residential (land)
 Broker Information Mehdi Mostaedi
 (760) 684-8044
 Status Active
 LoopNet ID 16992613

Property Notes

Listing's Link: <http://www.loopnet.com/lid/16992613>

Lots

#	Price	Size	Price/Size	Description
	\$99,000	\$19,800 /AC	5 AC	

Property Description

5 Acres vacant land located at the Southeast corner of Dennison Rd & Cielito Drive in Apple Valley. Just South of Bear Valley Road and East of Cetnral.



Price \$50,000
 Lot Size 7.50 AC
 Property Sub-type Residential (land)
 Broker Information Ricardo Pelayo
 (760) 559-5695
 Status Active
 LoopNet ID 16954443

Property Notes

Listing's Link: <http://www.loopnet.com/lid/16954443>

Lots

#	Price	Size	Price/Size	Description
39	\$50,000	\$6,666.67 /AC	7.50 AC	

Property Description

PRICE REDUCED FOR QUICK SALE!!!!!!!!!!!! Great place for your new home, new homes being built all around. Exceptional Views of the Valley! Close to electricity. of the mountains from this lot. Mobile homes and Horses allowed. Rurall area.

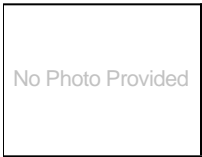

Price \$65,000
 Lot Size 4.04 AC
 Property Sub-type Residential (land)
 Broker Information Ricardo Pelayo
 (760) 559-5695
 Status Active
 LoopNet ID 16951622

Property Notes

Listing's Link: <http://www.loopnet.com/lid/16951622>

Lots

#	Price	Size	Price/Size	Description
70	\$65,000	\$16,089.15 /AC	4.04 AC	

Property Description

PRICE REDUCED FOR QUICK SALE!!!! Best priced property in the area! 5 Acres gross / Approx.4.04 Net Corner lot is rural area. Surrouned by some larger homes, all Fenced with chain link.Easy access, dirt road, but in good condition not too far from paved road, shopping and schools. New Custom Homes all around on over-sized Lots. Enjoy incredible sunsets over Quartzite Mountain. Bring your Horses, Live your Dream! Buyer to satisfy self as to boundaries, drainage, zoning, density, building requirements, cost and location of utilities and water. Electricity and Phone adjacent. Easy access.



Price \$62,800
 Lot Size 5 AC
 Property Sub-type Residential (land)
 Broker Information Ken Parker
 (760) 951-9050
 Status Active
 LoopNet ID 16922035

Property Notes

Listing's Link: <http://www.loopnet.com/lid/16922035>

Lots

#	Price	Size	Price/Size	Description
32	\$62,800	\$12,560 /AC	5 AC	

Property Description

Let's make a deal - Seller willing to carry or trade for what you might have...! Beautiful 5 acre, splittable lot with view of Valley, Mojave River and Mountains...! Grading Plan and homesite map available for Buyer's review...



Price \$279,000
 Lot Size 5.39 AC
 Property Sub-type Residential (land)
 Broker Information Laura Francis
 (626) 815-2600
 Status Active
 LoopNet ID 16881395

Property Notes

Listing's Link: <http://www.loopnet.com/lid/16881395>

Lots

#	Price	Size	Price/Size	Description
60-67	\$279,000	\$51,762.61 /AC	5.39 AC	8 lots

Property Description

Reduced over \$100K, this is a 5.39 acre parcel just south of the popular Skyline Ranch homes development and on Geronimo Rd. Lot has been split into 8 build able parcels at or near one half acre each. All utilities are accessible on Geronimo Rd. The street name is Desert Breeze Lane, but the improvements have not been completed. There are completion bonds in tact and paid, however buyer must obtain their own completion bonds at the close of escrow. Homes are 2,800 to 3,800 square feet and all approved by the Town of Apple Valley. Ready to break ground tomorrow and develop this great 8 home cul-de-sac. Sellers are licensed agents and Brokers and will consider trade for income property or single homes, and may carry and subordinate to qualified buyers. Submit your offers today, the market is on it's way up!! Drive by and sell!!!



Price \$1,470,000
 Lot Size 152 AC
 Property Sub-type Residential (land)
 Broker Information Tony Huang
 (954) 369-0334
 Status Active
 LoopNet ID 16812461

Property Notes

Listing's Link: <http://www.loopnet.com/lid/16812461>

Lots

#	Price	Size	Price/Size	Description
	\$1,470,000	\$9,671.05 /AC	152 AC	

Property Description

For more information and property documents <http://lunnen.com/listings/standing-rock-197> 152 ACRE TRACT GONE THROUGH OVER \$380,000 ON ENGINEERING AND ENTITLEMENT. ALL TEST AND STUDIES COMPLETED FOR 197 HALF-ACRE LOTS. SOLD FOR \$2,780,000 IN 2005. GREAT INVESTMENT FOR SHORT OR LONG TERM. SELLER FINANCING WITH 50% DOWN AND ATTRACTIVE TERMS.



Price \$55,000
 Lot Size 5 AC
 Property Sub-type Residential (land)
 Broker Information Ricardo Pelayo
 (760) 559-5695
 Status Active
 LoopNet ID 16596135

Property Notes

Listing's Link: <http://www.loopnet.com/lid/16596135>

Lots

#	Price	Size	Price/Size	Description
05	\$55,000	\$11,000 /AC	5 AC	

Property Description

Seller may carry the note with a decent down payment. Get a nice piece of land a full 4.93 Acres located at Milpas Highland area. Exceptional Unobstructed view of the Valley. Large custom homes are being built now in the immediate area. Explore all the possibilities and make your offer today before it's gone. Seller is highly motivated will look at all offers (Preferable cash). Power seems to be about 660 Ft. from property line. Property corner markers have been located and repainted already. You have to come and see this beautiful land. Please check plot map attached on the supplement link for a more detailed location of the property. Call listing agent if you need assistance to find it. Sign will be up soon. May be subdividable into 2.5 Acres, but check with the county for more information. APN: 0432032050000



Price \$95,000
 Lot Size 2.06 AC
 Property Sub-type Residential (land)
 Broker Information Ricardo Pelayo
 (760) 559-5695
 Status Active
 LoopNet ID 16596103

Property Notes

Listing's Link: <http://www.loopnet.com/lid/16596103>

Lots

#	Price	Size	Price/Size	Description
25	\$95,000	\$46,116.51 /AC	2.06 AC	

Property Description

Nice Level lot, Fully fenced with 8' commercial Chain Link. Electricity and Phone are just about 300Ft. east of property line. Many homes already around. This is the perfect place to build your new home, work shop and the place to bring your horses and toys. This property is located at the South East corner of the intersection of Potomac Rd. and Via Seco Rd. Owner does not want a sign at the property, but is very easy to locate. Decent condition Dirt Road Access. Corner lot, easy to access from two streets. See attached plot map for location. -----



Price \$45,500
 Lot Size 2.50 AC
 Property Sub-type Residential (land)
 Broker Information Ricardo Pelayo
 (760) 559-5695
 Status Active
 LoopNet ID 16596101

Property Notes

Listing's Link: <http://www.loopnet.com/lid/16596101>

Lots

#	Price	Size	Price/Size	Description
11	\$45,500	\$18,200 /AC	2.50 AC	

Property Description

Seller may carry the note with \$18000.00 Down @ 8% Interest for one to six years, Either amorized or Interest Only. Great level lot just south of Del Oro One lot in, all corners have been marked. Easy to find and easy access. There is access to the property according to title company throughout a 30Ft. Easement located on the east side of the property. New custom home being built about 400 Ft. from PIQ. Good dirt road access. Nice view of the mountains and valley. This is a good growing area, in Apple Valley east. Call agent if you have any questions. Property has been cleared. Other properties in the area are listed @ \$50,000.00+ per acre. See attached plot map for more location details. or call listing office if you need assistance to locate the property. -----
 ----- APN # 0435083110000



Price \$6,800,000
 Lot Size 0.01 AC
 Property Sub-type Residential (land)
 Broker Information Mehdi Mostaedi
 (760) 684-8044
 Status Active
 LoopNet ID 16554746

Property Notes

Listing's Link: <http://www.loopnet.com/lid/16554746>

Lots

#	Price	Size	Price/Size	Description
	\$6,800,000	\$622,285,714.29 /AC	0.01 AC	

Property Description

Approved Specific Plan: ±476 ACRES 808 Residential Units 46 Acres General Commercial, office, Retail 25 Acres Freeway Right Away Access North Pointe development is an approved and adopted specific plan by the Town of Apple Valley for a community of 518 homes, 290 apartments with a compliment of parks and 46 acres of commercial land set aside to support the residents and surrounding developments. In addition, the North Pointe development has specified 25 acres of freeway right-of-way access that straddles the commercial zone outlined in the specific plan.



Price \$359,000
 Lot Size 1.58 AC
 Property Sub-type Multifamily (land)
 Broker Information Mehdi Mostaedi
 (760) 684-8044
 Status Active
 LoopNet ID 16457123

Property Notes

Listing's Link: <http://www.loopnet.com/lid/16457123>

Lots

#	Price	Size	Price/Size	Description
	\$359,000	\$227,215.18 /AC	1.58 AC	

Property Description

*All utilities to site *Located in the best residential community in Apple Valley *Can build up to 24 units *Panoramic views of the Valley



Price \$395,000
 Lot Size 1.60 AC
 Property Sub-type Multifamily (land)
 Broker Information Mehdi Mostaedi
 (760) 684-8044
 Status Active
 LoopNet ID 16457115

Property Notes

Listing's Link: <http://www.loopnet.com/lid/16457115>

Lots

#	Price	Size	Price/Size	Description
	\$395,000	\$246,875 /AC	1.60 AC	

Property Description

*Could build up to 73 units *All utilities to site *Located in the prestigious Desert Knolls area of Apple Valley



Price \$229,000
 Lot Size 1.20 AC
 Property Sub-type Multifamily (land)
 Broker Information Mehdi Mostaedi
 (760) 684-8044
 Status Active
 LoopNet ID 16457107

Property Notes

Listing's Link: <http://www.loopnet.com/lid/16457107>

Lots

#	Price	Size	Price/Size	Description
	\$229,000	\$190,833.33 /AC	1.20 AC	

Property Description

*Size: 1.2Acres *Zoned: R-3 (Multi-Family) *Price: \$279,000 (\$5.34/ SF) *APN: 0473-351- 02 & 03 *Utilities at site *Located in the best residential community in Apple Valley *Panoramic Views of the Valley *Topography Maps Available



Price \$115,000
 Lot Size 0.57 AC
 Property Sub-type Multifamily (land)
 Broker Information Mehdi Mostaedi
 (760) 684-8044
 Status Active
 LoopNet ID 16457101

Property Notes

Listing's Link: <http://www.loopnet.com/lid/16457101>

Lots

#	Price	Size	Price/Size	Description
	\$115,000	\$201,754.39 /AC	0.57 AC	

Property Description

*Utilities at site *Located in the best residential community in Apple Valley *Panoramic views of the Valley *Topography Maps Available



Price \$49,000
 Lot Size 2.50 AC
 Property Sub-type Residential (land)
 Broker Information Ricardo Pelayo
 (760) 559-5695
 Status Active
 LoopNet ID 16322508

Property Notes

Listing's Link: <http://www.loopnet.com/lid/16322508>

Lots

#	Price	Size	Price/Size	Description
11	\$49,000	\$19,600 /AC	2.50 AC	

Property Description

Big Price Reduction.Seller's loss is your win. Seller may carry the note with \$10000.00 Down @ 6% Interest for one to seven years, Either amorized or Interest Only. Great level lot just south of Del Oro One lot in, all corners have been marked.Easy to find and easy access. There is access to the property according to title company throughout a 30Ft. Easement located on the east side of the property.New custom home being built about 400 Ft. from PIQ.Good dirt road access.Nice view of the mountains and valley.This is a good growing area,in Apple Valley east.Call agent if you have any questions. Property has been cleared..Other properties in the area are listed @ \$50,000.00+ per acre.See attached plot map for more location details. or call listing office if you need assistance to locate the property.



Price \$150,000
 Lot Size 10 AC
 Property Sub-type Residential (land)
 Broker Information Coldwell Banker Commercial
 (760) 684-8000
 Status Active
 LoopNet ID 16236545

Property Notes

Listing's Link: <http://www.loopnet.com/lid/16236545>

Lots

#	Price	Size	Price/Size	Description
	\$150,000	\$15,000 /AC	10 AC	
2	\$150,000	\$15,000 /AC	10 AC	
3	\$150,000	\$15,000 /AC	10 AC	
4	\$150,000	\$15,000 /AC	10 AC	

Property Description

Four (10 Acre) parcels available - total of 40 Acres. Can be purchased individually. Located in North Eastern Equestrian Center. Among beautiful homes and ranches. Ideal for small ranch. Located off of Hwy and Joshua on Esaws Rd.



Price \$195,000
 Lot Size 9 AC
 Property Sub-type Residential (land)
 Broker Information Coldwell Banker Commercial
 (760) 684-8000
 Status Active
 LoopNet ID 16236501

Property Notes

Listing's Link: <http://www.loopnet.com/lid/16236501>

Lots

#	Price	Size	Price/Size	Description
	\$195,000	\$21,666.67 /AC	9 AC	

Property Description

Price Reduced!!! Beautiful 9 acre property located among Apple Valley's finest ranches. Perfect for your ranch or private estate with the possibility of splitting the parcel into three separate parcels, three acres each. Tentative map in process and may be assumed by purchaser.



Price \$700,000
 Lot Size 40 AC
 Property Sub-type Residential (land)
 Broker Information Coldwell Banker Commercial
 (760) 684-8000
 Status Active
 LoopNet ID 16236469

Property Notes

Listing's Link: <http://www.loopnet.com/lid/16236469>

Lots

#	Price	Size	Price/Size	Description
	\$700,000	\$17,500 /AC	40 AC	

Property Description

Approved Short Sale - Price Reduced by \$500,000! 40 Acres on Del Oro off Deep Creek and Bear Valley Rd. Fast growing Apple Valley, beautiful views of the valley. Tentative tract map of 52 lots. \$400,000 down and owner will carry 5 years at 8%.



Price \$3,795,000
 Lot Size 17.46 AC
 Property Sub-type Residential (land)
 Broker Information Capital Holdings, Inc.
 (909) 476-9800
 Status Active
 LoopNet ID 16203768

Property Notes

Listing's Link: <http://www.loopnet.com/lid/16203768>

Lots

#	Price	Size	Price/Size	Description
	\$3,795,000	\$217,353.96 /AC	17.46 AC	

Property Description

17.46 acre property in prime location. west side of property faces I-15 for maximum exposure. Must see!



Price \$175,000
 Lot Size 2 AC
 Property Sub-type Residential (land)
 Broker Information jason lamoreaux
 (760) 792-8338
 Status Active
 LoopNet ID 16136829

Property Notes

Listing's Link: <http://www.loopnet.com/lid/16136829>

Lots

#	Price	Size	Price/Size	Description
	\$175,000	\$87,500 /AC	2 AC	

Property Description

Beautiful TWO acre equestrian property located in a highly desired area of Apple Valley. Property has wonderful views of the valley in a very serene setting. The property has recently been completely fenced and gated, with a Three Rail Ranch PVC which includes a limited lifetime warranty not to discolor or become brittle. In addition, a new well has been drilled (February of 2006) to 300 feet & a 20 GPM pump including a 85 gallon pressure tank has been installed. Why wait ONE YEAR for a well when this property is ready to build your home on! Please call for more details.



Price \$295,000
 Lot Size 9 AC
 Property Sub-type Residential (land)
 Broker Information jason lamoreaux
 (760) 792-8338
 Status Active
 LoopNet ID 16136803

Property Notes

Listing's Link: <http://www.loopnet.com/lid/16136803>

Lots

#	Price	Size	Price/Size	Description
	\$295,000	\$32,777.78 /AC	9 AC	

Property Description

Beautiful nine acre property located among Apple Valley's finest ranches. Perfect for your ranch or private estate with the possibility of splitting the parcel into three separate parcels, three acres each. Tentative map on process and may be assumed by purchaser. Terms available. Call for details.



Price \$39,500
 Lot Size 5 AC
 Property Sub-type Residential (land)
 Broker Information Coldwell Banker Commercial
 (760) 684-8000
 Status Active
 LoopNet ID 16136654

Property Notes

Listing's Link: <http://www.loopnet.com/lid/16136654>

Lots

#	Price	Size	Price/Size	Description
	\$39,500	\$7,900 /AC	5 AC	

Property Description

"Beautiful 5 Acre Parcel Ready For You!"

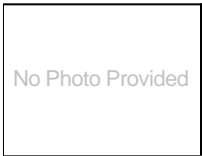

Price \$565,000
 Lot Size 9.24 AC
 No. Beds 8
 Property Sub-type Residential (land)
 Broker Information Angela Slayton
 (714) 539-0323
 Status Active
 LoopNet ID 15271149

Property Notes

Listing's Link: <http://www.loopnet.com/lid/15271149>

Lots

#	Price	Size	Price/Size	Description
	\$565,000	\$61,147.19 /AC	9.24 AC	

Property Description

We have about 200 parcels of land from 5 acres to over 150 acres . Owner will carry back a large note. Try 20% down. We will exchange this property or any of the others from our client's portfolio for income producing properties (preferably in San Bernardino or Riverside Counties but will consider others). Our client has in excess of \$50M in properties. These parcels have been hand picked for being directly in the path of development in the Victorville, Apple Valley, Adelanto and Barstow area. 9.24AC APPLE VALLEY, CA. Residential Zoned Area (4 units / AC) or Church. Property is located near the planned "DesertXpress Station" (NEW INTERSTATE HIGH SPEED RAIL) 1.6 miles East of the Interstate 15. \$565,000.00

71 NWC OF TUSSING RANCH RD & CARIBOU AV, Apple Valley, CA 92308



Price \$4,500,000
Lot Size 30 AC
Property Sub-type Residential (land)
Broker Information Garry Hou
(626) 236-7537
Status Active
LoopNet ID 15029079

Property Notes

Listing's Link: <http://www.loopnet.com/lid/15029079>

Lots

#	Price	Size	Price/Size	Description
	\$4,500,000	\$150,000 /AC	30 AC	

Property Description

RESIDENTIAL EQUESTRIAN (1 DU PER 0.4 TO 0.9 NET ACRES)

72 DALE EVANS PARKWAY & CORWIN ROAD, APPLE VALLEY, CA 92307



Price \$2,275,000
Lot Size 20 AC
Property Sub-type Residential (land)
Broker Information Dilip Sheth
(310) 266-2754
Status Active
LoopNet ID 14578306

Property Notes

Listing's Link: <http://www.loopnet.com/lid/14578306>

Lots

#	Price	Size	Price/Size	Description
	\$2,275,000	\$113,750 /AC	20 AC	

Property Description

35-LOT SUBDIVISION IN APPLE VALLEY - 1/2 ACRE LOTS (\$65 K /LOT WITH FINAL MAP) FOR CUSTOM HOMES IN EQUESTRIAN ZONED AREA WITH TRAILS. PROPERTY COMMANDS VIEWS OF THE MOUNTAINS. MAJOR HOMEBUILDERS BUILDING IN THE AREA. HOMES EXPECTED IN THE \$500,000+ PRICE RANGE. TENTATIVE MAP IS APPROVED. FINAL MAP READY TO RECORD @ COE. PULL GRADING PERMIT & START CONSTRUCTION. UTILITIES NEARBY. ACCESS FROM DALE EVANS PARKWAY VIA SOUTH STREET.

73 PROPERTY REDUCED, Apple Valley, CA 92307



Price \$1,200,000
Lot Size 40 AC
Property Sub-type Residential (land)
Broker Information Tom Hopkins
(760) 245-1511
Status Active
LoopNet ID 14508578

Property Notes

Listing's Link: <http://www.loopnet.com/lid/14508578>

Lots

#	Price	Size	Price/Size	Description
	\$1,200,000	\$30,000 /AC	40 AC	

Property Description

ATTENTION DEVELOPERS AND INVESTORS 40 acres of view property for sale by Owners Located in Apple Valley area of Southern California Forever view of Mountains, Valley, City & Desert 40 acres sub dividable into 16 each 2.5 acre ranches JUST REDUCED TO \$30,000 per acre for a total of \$1,200,000 Information sheet and parcel map available

74 Oldenberg Rd., Apple Valley, CA 92307

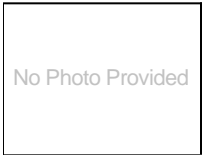

Price \$79,950
Lot Size 5 AC
Property Sub-type Residential (land)
Broker Information Peter Zarrabian
(778) 233-1768
Status Active
LoopNet ID 652566

Property Notes

Listing's Link: <http://www.loopnet.com/lid/652566>

Lots

#	Price	Size	Price/Size	Description
	\$79,950	\$15,990 /AC	5 AC	

Property Description

IN FAIRVIEW VALLEY AP# 464-022-32. Described as S 1/2 SW 1/4 SW 1/4 SW 1/4 Sec. 27 T6N R2W. Corner lot of Oldenberg Rd. Flat, level & square. Power available, water by individual wells. Homes in the area. S.B. Thomas map p. 320 E1. Holiday Ranch is close by.