

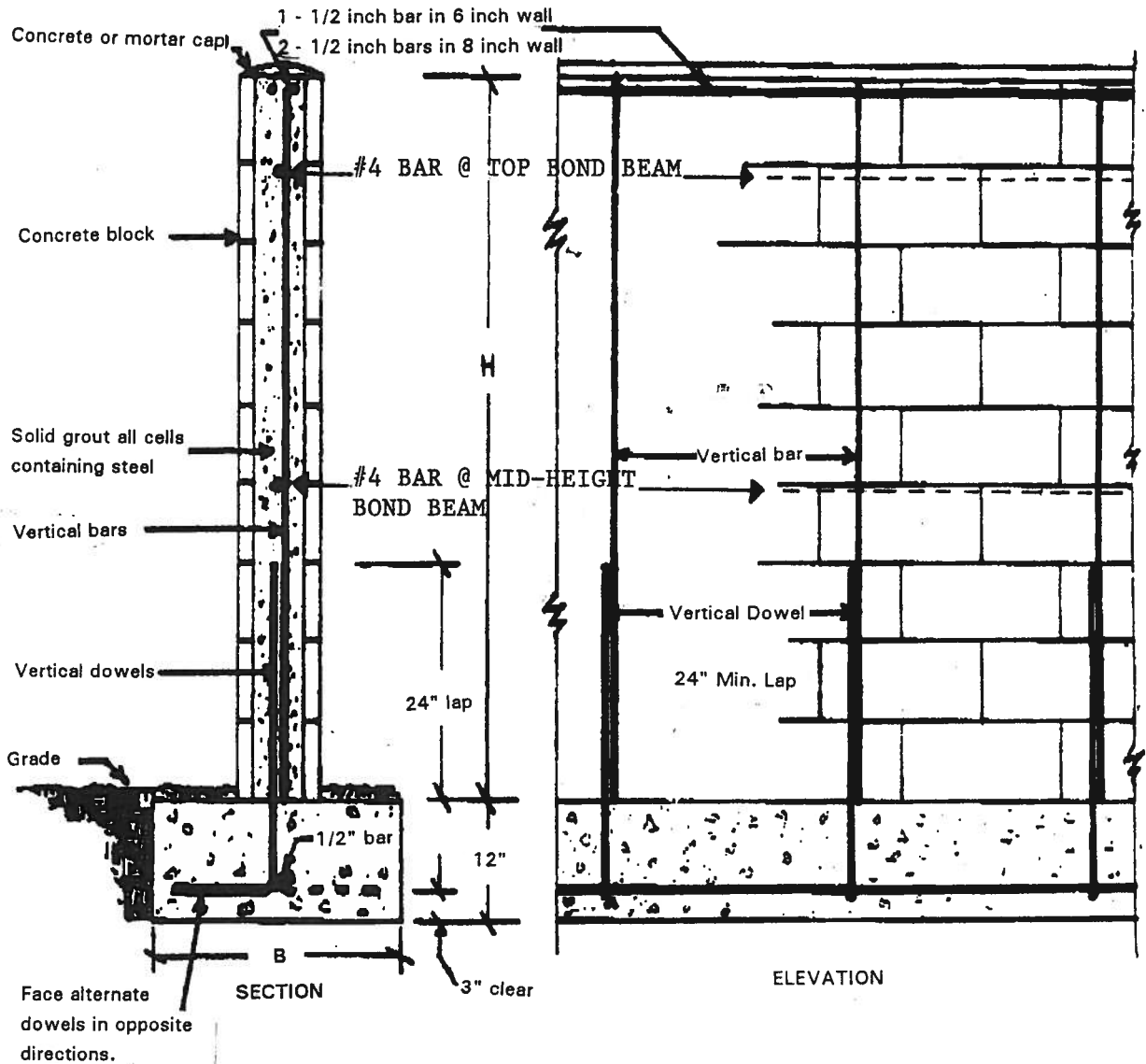

TOWN OF APPLE VALLEY

DIVISION OF BUILDING SERVICES

STANDARD DETAIL - GARDEN WALL Not for retaining earth or supporting structures



H	B	Vertical Reinforcing
6' 0"	24"	1/2" at 32" o.c.
5' 0"	20"	1/2" at 32" o.c.
4' 0"	16"	3/8" at 48" o.c.
3' 0"	12"	3/8" at 48" o.c.

SEE PAGE 2 FOR CONSTRUCTION NOTES

NOTES:

1. The maximum allowable height for a fence is 6'0". Any fences over 6' in height require engineered plans and a Building Permit. Check with the Division of Building and Safety or Planning to verify special conditions on fence height restrictions in setbacks, front or side yards, easements and/or in clear-site triangles.
2. A Building Permit is not required for fences 6' or less in height **unless** retaining earth, supporting a sur-charge load or required as a Condition of Approval.
3. If a Building Permit is required, a pre-construction inspection is necessary prior to beginning work.
4. If a Building Permit is required, the Town Planning Division requires the submittal of a site plan showing the height and location of all proposed fences relative to the property boundaries and existing structures. Common fences shared by two or more property owners shall require an approval letter from all of the affected property owners.

INSTRUCTION FOR USING THIS STANDARD DETAIL:

1. Cells that require grout are to be in vertical alignment and free from obstructions. Lay block in 1/2" bond.
2. Grout to be puddled, rodded or vibrated and consolidated.
3. Footing to be dug 12" minimum into undisturbed soil.
4. Footings where the surface of the ground slopes more than 1 foot in 10 shall be level or shall be stepped so that both the top and bottom of such footings are level.
5. Masonry fences using Slump Stone & more than 4' in height are required to be 8" wide **OR** the following adjustments to this detail apply for 6" Slump Stone:
 - a. No splice in vertical steel.
 - b. Cleanouts @ all vertical steel cell with mortar fins removed.
 - c. Horizontal steel splices stacked for maximum grout clearance.
 - d. Steel centered & tied for inspection.
 - e. Vertical steel minimum #4 @ 24" o.c.
6. Request all inspections prior to pouring or grouting.